



SMB/SMC/SMS SMB/SMC/SMS

Contents

8.1	Straight Plug Crimp	175
8.2	Angle Plug Crimp	175
8.3	Bulkhead Plug	176
8.4	Bulkhead Plug Crimp	176
8.5	Bulkhead Receptacle, male	178
8.6	Press-In Bulkhead Receptacle, male	180
8.7	Straight Receptacle, male, for Printed Circuits in Press-In Technology	180
8.8	Angle Receptacle, male, for Printed Circuits in Press-In Technology	180
8.9	Receptacle, male, for Printed Circuits	181
8.10	Straight PCB Receptacle, male, in SMT and Edge-Mount	181
8.11	Angle Receptacle, male, for Printed Circuits	182
8.12	Straight Jack	183
8.13	Angle Jack	186
8.14	Angle Jack Crimp	187
8.15	Straight PCB Receptacle, female, in SMT	188
8.16	Angle PCB Receptacle, female	189
8.17	T Adaptor	189
8.18	Termination, female	189

Übersicht

8.1	Kabelstecker Crimp	175
8.2	Kabelwinkelstecker Crimp	175
8.3	Kabeleinbaustecker	176
8.4	Kabeleinbaustecker Crimp	176
8.5	Einbaustecker	178
8.6	Einpresstecker	180
8.7	Stecker für gedruckte Schaltungen in Einpresstechnik	180
8.8	Winkelstecker für gedruckte Schaltungen in Einpresstechnik	180
8.9	Anbaustecker für gedruckte Schaltungen	181
8.10	Stecker in SMT und Edge-Mount	181
8.11	Winkelanbaustecker für gedruckte Schaltungen	182
8.12	Kabelbuchse	183
8.13	Kabelwinkelbuchse	186
8.14	Kabelwinkelbuchse Crimp	187
8.15	Buchse in SMT	188
8.16	Winkelanbaubuchse für gedruckte Schaltungen	189
8.17	T-Stück	189
8.18	Abschlusswiderstand	189

Straight Plug Crimp
Kabelstecker Crimp

8.1

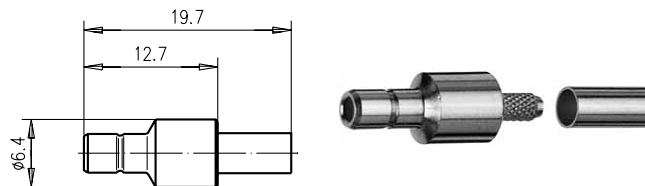

Order no. Bestell-Nr.	Series Serie	Cable group; cable Kabelgruppe; Kabel	Finish Oberfläche	Remarks Anmerkungen	Assembly Montage	Crimp die Crimpeinsatz
J01160A0401	SMB	G7 (RG-316/U)	Gold (Standard)	crimp/crimp	C1616	N01001A0009
J01160A0409	SMB	G7 (RG-316/U)	Nickel	crimp/crimp	C1616	N01001A0009
J01160A0471	SMB	G8 (RD-316)	Gold (Standard)	crimp/crimp	C1620	N01001A0014
J01160A0479	SMB	G8 (RD-316)	Nickel	crimp/crimp	C1620	N01001A0014

Angle Plug Crimp
Kabelwinkelstecker Crimp

8.2

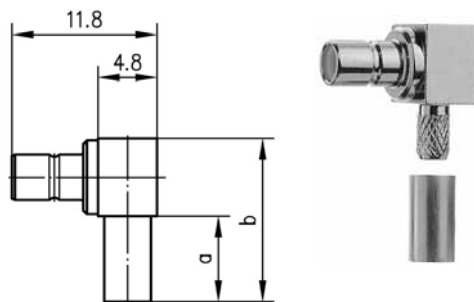

Order no. Bestell-Nr.	Series Serie	Cable group; cable Kabelgruppe; Kabel	Finish Oberfläche	Assembly Montage	Crimp die Crimpeinsatz
J01160A0551	SMB	G3 (RG-178B/U)	Gold (Standard)	C3413	N01001A0010
J01160A0558	SMB	G3 (RG-178B/U)	Telealloy (white bronze)	C3413	N01001A0010
J01160A0531	SMB	G7 (RG-316/U)	Gold (Standard)	C3403	N01001A0009
J01160A0538	SMB	G7 (RG-316/U)	Telealloy (white bronze)	C3403	N01001A0009
J01160A0561	SMB	G8 (RD-316)	Gold (Standard)	C3414	N01001A0014
J01160A0568	SMB	G8 (RD-316)	Telealloy (white bronze)	C3414	N01001A0014

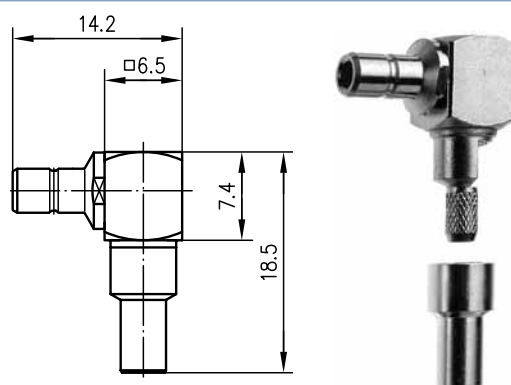

Order no. Bestell-Nr.	Series Serie	Cable group; cable Kabelgruppe; Kabel	Finish Oberfläche	Assembly Montage	Crimp die Crimpeinsatz
J01160A0281	SMB	G7 (RG-316/U)	Gold (Standard)	C1003	N01001A0009
J01160A0288	SMB	G7 (RG-316/U)	Telealloy (white bronze)	C1003	N01001A0009

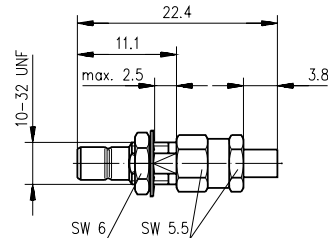
Bulkhead Plug
Kabeleinbaustecker

Order no. Bestell-Nr.	Series Serie	Cable group; cable Kabelgruppe; Kabel	Finish Oberfläche	Mount. dim. Einbaumaß	Assembly Montage
J01160A0151	SMB	G11 (UT-85)	Gold (Standard)	Z24	C17
J01160A0159	SMB	G11 (UT-85)	Nickel	Z24	C17

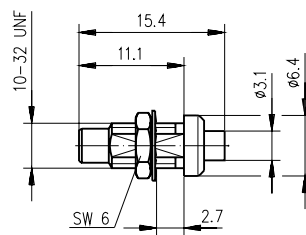

Order no. Bestell-Nr.	Series Serie	Cable group; cable Kabelgruppe; Kabel	Finish Oberfläche	Mount. dim. Einbaumaß	Assembly Montage
J01170A0161	SMC	G11 (UT-85)	Gold (Standard)	Z24	C19

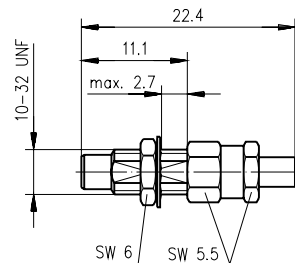

Order no. Bestell-Nr.	Series Serie	Cable group; cable Kabelgruppe; Kabel	Finish Oberfläche	Mount. dim. Einbaumaß	Assembly Montage
J01170A0061	SMC	G11 (UT-85)	Gold (Standard)	Z24	C17
J01170A0069	SMC	G11 (UT-85)	Nickel	Z24	C17

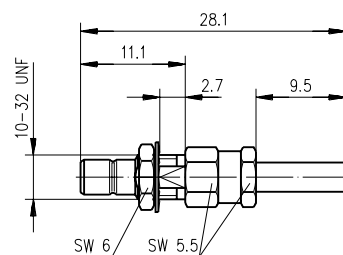
Bulkhead Plug Crimp
Kabeleinbaustecker Crimp

Order no. Bestell-Nr.	Series Serie	Cable group; cable Kabelgruppe; Kabel	Finish Oberfläche	Remarks Anmerkungen	Mount. dim. Einbaumaß	Assembly Montage	Crimp die Crimpeinsatz
J01160A0091	SMB	G3 (RG-178B/U)	Gold (Standard)	solder/crimp löt/crimp	Z24	C1413	N01001A0010

Order no. Bestell-Nr.	Series Serie	Cable group; cable Kabelgruppe; Kabel	Finish Oberfläche	Remarks Anmerkungen	Mount. dim. Einbaumaß	Assembly Montage	Crimp die Crimpeinsatz
J01160A0099	SMB	G3 (RG-178B/U)	Nickel	solder/crimp löt/crimp	Z24	C1413	N01001A0010
J01160A0101	SMB	G7 (RG-316/U)	Gold (Standard)	solder/crimp löt/crimp	Z24	C1403	N01001A0010
J01160A0109	SMB	G7 (RG-316/U)	Nickel	solder/crimp löt/crimp	Z24	C1403	N01001A0010
J01160A0111	SMB	G8 (RD-316)	Gold (Standard)	solder/crimp löt/crimp	Z24	C1414	N01001A0014
J01160A0119	SMB	G8 (RD-316)	Nickel	solder/crimp löt/crimp	Z24	C1414	N01001A0014

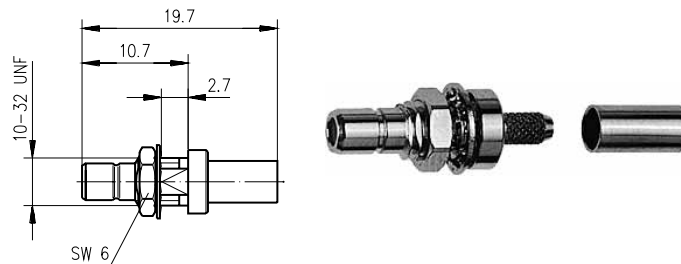

Order no. Bestell-Nr.	Series Serie	Cable group; cable Kabelgruppe; Kabel	Finish Oberfläche	Remarks Anmerkungen	Mount. dim. Einbaumaß	Assembly Montage	Crimp die Crimpeinsatz
J01160A0381	SMB	G3 (RG-178B/U)	Gold (Standard)	crimp/crimp	Z24	C1617	N01001A0010
J01160A0388	SMB	G3 (RG-178B/U)	Tealloy (white bronze)	crimp/crimp	Z24	C1617	N01001A0010
J01160A0389	SMB	G3 (RG-178B/U)	Nickel	crimp/crimp	Z24	C1617	N01001A0010
J01160A0391	SMB	G7 (RG-316/U)	Gold (Standard)	crimp/crimp	Z24	C1616	N01001A0009
J01160A0398	SMB	G7 (RG-316/U)	Tealloy (white bronze)	crimp/crimp	Z24	C1616	N01001A0009
J01160A0399	SMB	G7 (RG-316/U)	Nickel	crimp/crimp	Z24	C1616	N01001A0009
J01160A0321	SMB	G8 (RD-316)	Gold (Standard)	crimp/crimp	Z24	C1620	N01001A0014
J01160A0328	SMB	G8 (RD-316)	Tealloy (white bronze)	crimp/crimp	Z24	C1620	N01001A0014

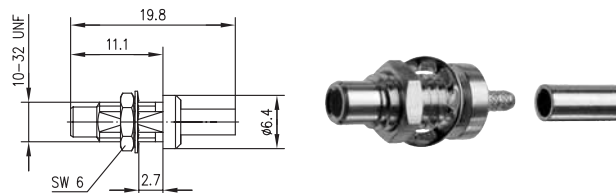

Order no. Bestell-Nr.	Series Serie	Cable group; cable Kabelgruppe; Kabel	Finish Oberfläche	Remarks Anmerkungen	Mount. dim. Einbaumaß	Assembly Montage	Crimp die Crimpeinsatz
J01170A0151	SMC	G3 (RG-178B/U)	Gold (Standard)	crimp/crimp	Z24	C1617	N01001A0010

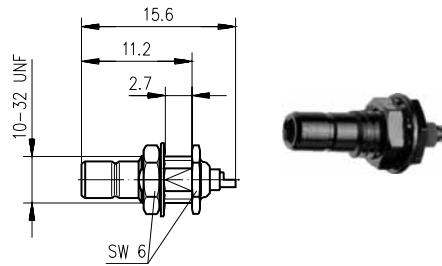
Bulkhead Receptacle, male
Einbaustecker

Order no. Bestell-Nr.	Series Serie	Finish Oberfläche	Remarks Anmerkungen	Mount. dim. Einbaumaß
J01160A0031	SMB	Gold (Standard)	rear mounting Einbau von hinten	Z24
J01160A0039	SMB	Nickel	rear mounting Einbau von hinten	Z24

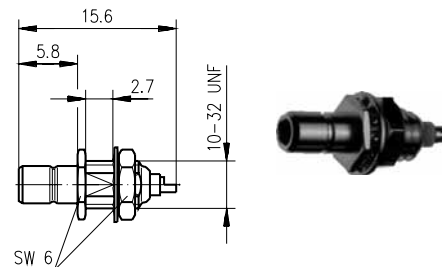

Order no. Bestell-Nr.	Series Serie	Finish Oberfläche	Remarks Anmerkungen	Mount. dim. Einbaumaß
J01160A0021	SMB	Gold (Standard)	front mounting Einbau von vorne	Z24
J01160A0029	SMB	Nickel	front mounting Einbau von vorne	Z24

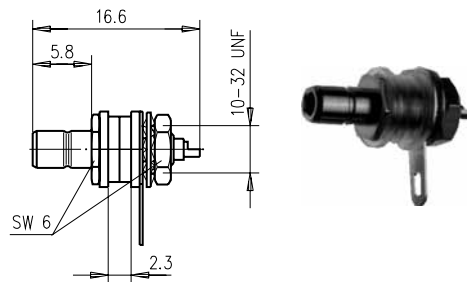

Order no. Bestell-Nr.	Series Serie	Finish Oberfläche	Remarks Anmerkungen	Mount. dim. Einbaumaß
J01160A0271	SMB	Gold (Standard)	front mounting with insulating washers Einbau von vorne mit Isolierscheiben	Z45
J01160A0279	SMB	Nickel	front mounting with insulating washers Einbau von vorne mit Isolierscheiben	Z45

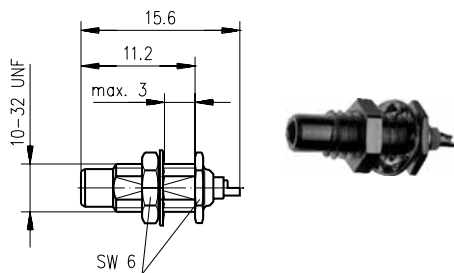

Order no. Bestell-Nr.	Series Serie	Finish Oberfläche	Remarks Anmerkungen	Mount. dim. Einbaumaß
J01170A0011	SMC	Gold (Standard)	rear mounting Einbau von hinten	Z24
J01170A0019	SMC	Nickel	rear mounting Einbau von hinten	Z24

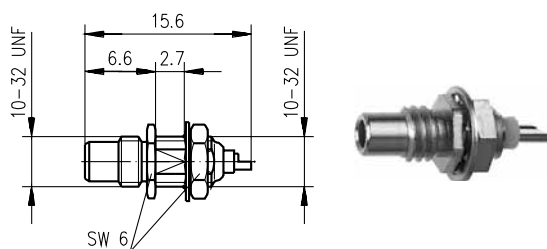

Order no. Bestell-Nr.	Series Serie	Finish Oberfläche	Remarks Anmerkungen	Mount. dim. Einbaumaß
J01170A0001	SMC	Gold (Standard)	front mounting Einbau von vorne	Z24
J01170A0009	SMC	Nickel	front mounting Einbau von vorne	Z24

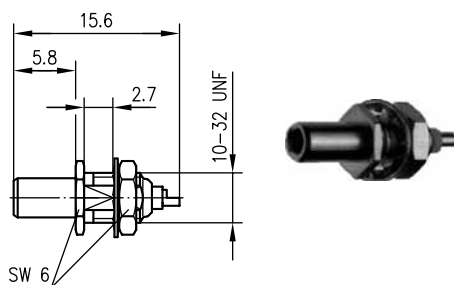

Order no. Bestell-Nr.	Series Serie	Finish Oberfläche	Remarks Anmerkungen	Mount. dim. Einbaumaß
J01180A0031	SMC	Gold (Standard)	front mounting Einbau von vorne	Z24
J01180A0039	SMC	Nickel	front mounting Einbau von vorne	Z24

8.6

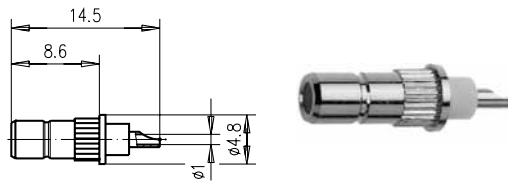
Press-In Bulkhead Receptacle, male
Einpresstecker

Order no. Bestell-Nr.	Series Serie	Finish Oberfläche	Remarks Anmerkungen	Mount. dim. Einbaumaß
J01160A0341	SMB	Gold (Standard)	rear mounting Einbau von hinten	Z44
J01160A0349	SMB	Nickel	rear mounting Einbau von hinten	Z44

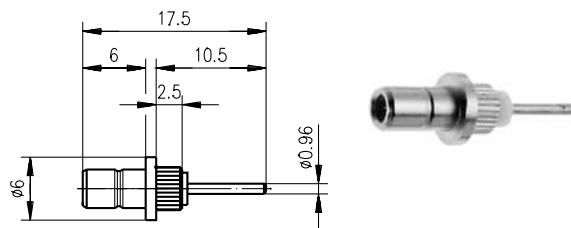

Order no. Bestell-Nr.	Series Serie	Finish Oberfläche	Remarks Anmerkungen	Mount. dim. Einbaumaß
J01160A0449	SMB	Nickel	front mounting Einbau von vorne	Z44

8.7

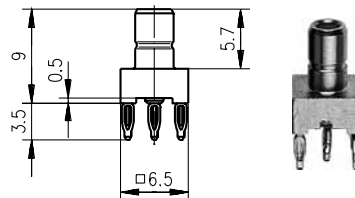
Straight Receptacle, male, for Printed Circuits in Press-In Technology
Stecker für gedruckte Schaltungen in Einpresstechnik

Order no. Bestell-Nr.	Series Serie	Finish Oberfläche	Remarks Anmerkungen	Mount. dim. Einbaumaß
J01160A0431	SMB	Gold (Standard)	Further technical information on request Weitere technische Informationen auf Anfrage	Z78

8.8

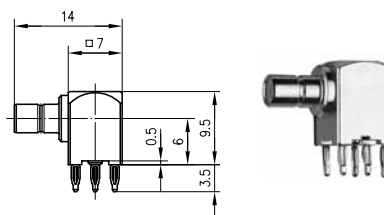
Angle Receptacle, male, for Printed Circuits in Press-In Technology
Winkelstecker für gedruckte Schaltungen in Einpresstechnik

Order no. Bestell-Nr.	Series Serie	Finish Oberfläche	Remarks Anmerkungen	Mount. dim. Einbaumaß
J01160A0511	SMB	Gold (Standard)	Further technical information on request Weitere technische Informationen auf Anfrage	Z78

Receptacle, male, for Printed Circuits
Anbaustecker für gedruckte Schaltungen

8.9

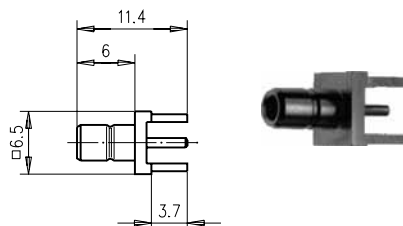

Order no. Bestell-Nr.	Series Serie	Finish Oberfläche	Mount. dim. Einbaumaß
J01160A0211	SMB	Gold (Standard)	Z25
J01160A0218	SMB	Telealloy (white bronze)	Z25

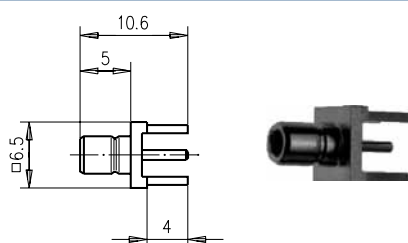

Order no. Bestell-Nr.	Series Serie	Finish Oberfläche	Mount. dim. Einbaumaß
J01160A0311	SMB	Gold (Standard)	Z25
J01160A0318	SMB	Telealloy (white bronze)	Z25

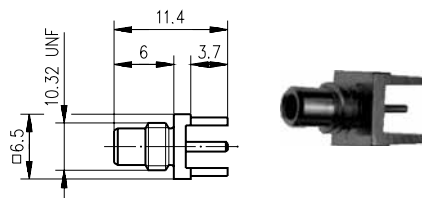

Order no. Bestell-Nr.	Series Serie	Finish Oberfläche	Mount. dim. Einbaumaß
J01170A0131	SMC	Gold (Standard)	Z25
J01170A0138	SMC	Telealloy (white bronze)	Z25

Straight PCB Receptacle, male, in SMT and Edge-Mount
Stecker in SMT und Edge-Mount

8.10

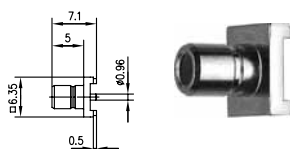

Order no. Bestell-Nr.	Series Serie	Finish Oberfläche	Mount. dim. Einbaumaß
J01160A0421	SMB	Gold (Standard)	Z72
J01160A0428	SMB	Telealloy (white bronze)	Z72

8.10

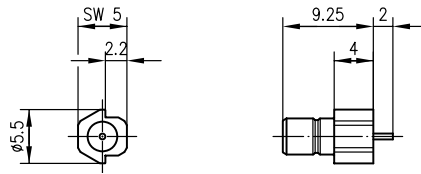
Straight PCB Receptacle, male, in SMT and Edge-Mount
Stecker in SMT und Edge-Mount

Order no. Bestell-Nr.	Series Serie	Finish Oberfläche	Remarks Anmerkungen	Mount. dim. Einbaumaß
J01160A0501	SMB	Gold (Standard)	Edge-Mount-Type	Z94

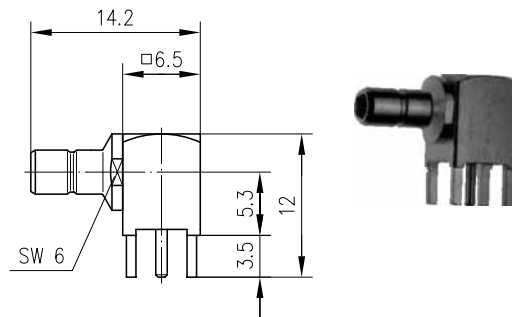
Angle Receptacle, male, for Printed Circuits
Winkelanbaustecker für gedruckte Schaltungen

Order no. Bestell-Nr.	Series Serie	Finish Oberfläche	Mount. dim. Einbaumaß
J01160A0231	SMB	Gold (Standard)	Z25
J01160A0238	SMB	Telealloy (white bronze)	Z25

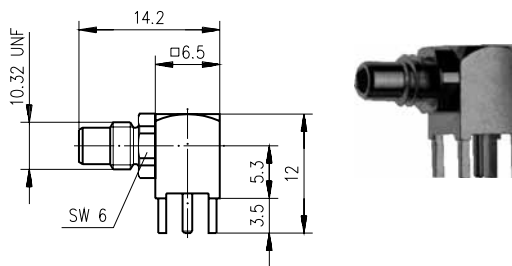

Order no. Bestell-Nr.	Series Serie	Finish Oberfläche	Mount. dim. Einbaumaß
J01170A0101	SMC	Gold (Standard)	Z25
J01170A0107	SMC	Type for printed circuits (tinned solder pins) Leiterplatten-Ausführung (verzinnter Lötanschluss)	Z25
J01170A0108	SMC	Telealloy (white bronze)	Z25

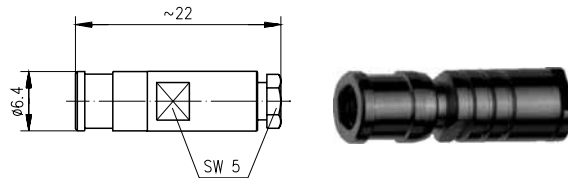

Order no. Bestell-Nr.	Series Serie	Cable group; cable Kabelgruppe; Kabel	Finish Oberfläche	Remarks Anmerkungen	Assembly Montage
J01161A0021	SMB	G3 (RG-178B/U)	Gold (Standard)	with pressure sleeve mit Stopfbuchsenverschraubung	C03
J01161A0029	SMB	G3 (RG-178B/U)	Nickel	with pressure sleeve mit Stopfbuchsenverschraubung	C03
J01161A0301	SMB	G7 (RG-316/U)	Gold (Standard)	with pressure sleeve mit Stopfbuchsenverschraubung	C03
J01161A0309	SMB	G7 (RG-316/U)	Nickel	with pressure sleeve mit Stopfbuchsenverschraubung	C03

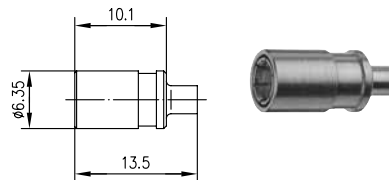

Order no. Bestell-Nr.	Series Serie	Cable group; cable Kabelgruppe; Kabel	Finish Oberfläche	Remarks Anmerkungen	Assembly Montage
J01161A0281	SMB	G11 (UT-85)	Gold (Standard)	solder/solder löt/löt	C25
J01161A0288	SMB	G11 (UT-85)	Telealloy (white bronze)	solder/solder löt/löt	C25
J01161A0321	SMB	G10 (UT-141)	Gold (Standard)	solder/solder löt/löt	C25
J01161A0328	SMB	G10 (UT-141)	Telealloy (white bronze)	solder/solder löt/löt	C25

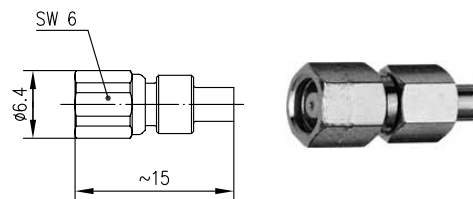

Order no. Bestell-Nr.	Series Serie	Cable group; cable Kabelgruppe; Kabel	Finish Oberfläche	Remarks Anmerkungen	Assembly Montage
J01171A0041	SMC	G11 (UT-85)	Gold (Standard)	crimp/solder crimp/löt	C06
J01171A0048	SMC	G11 (UT-85)	Telealloy (white bronze)	crimp/solder crimp/löt	C06
J01171A0051	SMC	G10 (UT-141)	Gold (Standard)	solder/solder löt/löt	C07
J01171A0058	SMC	G10 (UT-141)	Telealloy (white bronze)	solder/solder löt/löt	C07

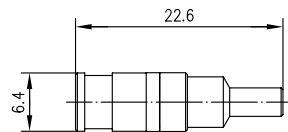
Straight Jack Crimp
Kabelbuchse Crimp

Order no. Bestell-Nr.	Series Serie	Cable group; cable Kabelgruppe; Kabel	Finish Oberfläche	Remarks Anmerkungen	Assembly Montage	Crimp die Crimpeinsatz
J01161A0331	SMB	G3 (RG-178B/U)	Gold (Standard)	solder/crimp löt/crimp	C1013	N01001A0010
J01161A0339	SMB	G3 (RG-178B/U)	Nickel	solder/crimp löt/crimp	C1013	N01001A0010
J01161A0341	SMB	G7 (RG-316/U)	Gold (Standard)	solder/crimp löt/crimp	C1003	N01001A0009
J01161A0349	SMB	G7 (RG-316/U)	Nickel	solder/crimp löt/crimp	C1003	N01001A0009
J01161A0351	SMB	G8 (RD-316)	Gold (Standard)	solder/crimp löt/crimp	C1014	N01001A0014
J01161A0359	SMB	G8 (RD-316)	Nickel	solder/crimp löt/crimp	C1014	N01001A0014

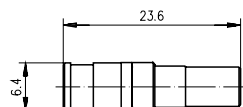

Order no. Bestell-Nr.	Series Serie	Cable group; cable Kabelgruppe; Kabel	Finish Oberfläche	Remarks Anmerkungen	Dimensions Abmessungen	Crimp die Crimpeinsatz
J01161A0471	SMB	G13 (0.4/2.5); 02YS (ST) CH 0.45/2.0-3.4 Leoni; 02Y (ST) CH 0.45/2.0-3.4 Bedea; 02Y (ST) CY 0.45/2.0-3.4 Siemens; NCX1 391300 0.53/2.45-3.6 Filotex	Gold (Standard)	solder/crimp löt/crimp	C1004	N01001L1274
J01161A0479	SMB	G13 (0.4/2.5); 02YS (ST) CH 0.45/2.0-3.4 Leoni; 02Y (ST) CH 0.45/2.0-3.4 Bedea; 02Y (ST) CY 0.45/2.0-3.4 Siemens; NCX1 391300 0.53/2.45-3.6 Filotex	Nickel	solder/crimp löt/crimp	C1004	N01001L1274

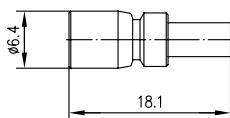

Order no. Bestell-Nr.	Series Serie	Cable group; cable Kabelgruppe; Kabel	Finish Oberfläche	Remarks Anmerkungen	Assembly Montage	Crimp die Crimpeinsatz
J01161A0651	SMB	G12 (0.315/1.95-3.7)	Gold (Standard)	solder/crimp löt/crimp	C1604	N01001L1274

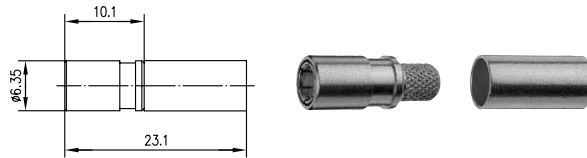

Order no. Bestell-Nr.	Series Serie	Cable group; cable Kabelgruppe; Kabel	Finish Oberfläche	Remarks Anmerkungen	Assembly Montage	Crimp die Crimpeinsatz
J01161A0391	SMB	G1 (RG-58C/U)	Gold (Standard)	crimp/crimp	C4127	N01001A0039
J01161A0398	SMB	G1 (RG-58C/U)	Tealloy (white bronze)	crimp/crimp	C4127	N01001A0039

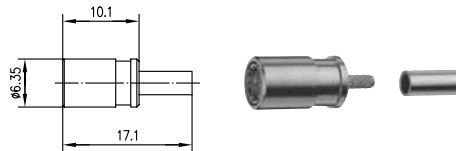

Order no. Bestell-Nr.	Series Serie	Cable group; cable Kabelgruppe; Kabel	Finish Oberfläche	Remarks Anmerkungen	Assembly Montage	Crimp die Crimpeinsatz
J01161A0291	SMB	G3 (RG-178B/U)	Gold (Standard)	crimp/crimp	C4117	N01001A0010
J01161A0298	SMB	G3 (RG-178B/U)	Tealloy (white bronze)	crimp/crimp	C4117	N01001A0010
J01161A0461	SMB	K 01252 D	Gold (Standard)	crimp/crimp	C4117	N01001A0010
J01161A0468	SMB	K 01252 D	Tealloy (white bronze)	crimp/crimp	C4117	N01001A0010
J01161A0691	SMB	G7 (RG-316/U)	Gold (Standard)	crimp/crimp	C4116	N01001A0009
J01161A0698	SMB	G7 (RG-316/U)	Tealloy (white bronze)	crimp/crimp	C4116	N01001A0009
J01161A0701	SMB	G8 (RD-316)	Gold (Standard)	crimp/crimp	C4120	N01001A0014
J01161A0708	SMB	G8 (RD-316)	Tealloy (white bronze)	crimp/crimp	C4120	N01001A0014

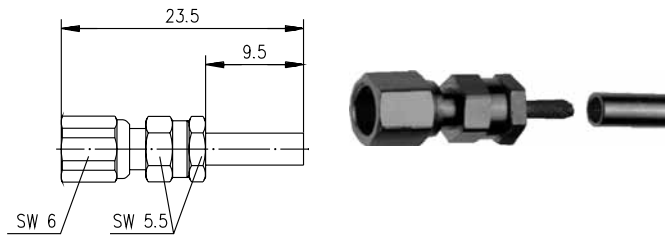

Order no. Bestell-Nr.	Series Serie	Cable group; cable Kabelgruppe; Kabel	Finish Oberfläche	Remarks Anmerkungen	Assembly Montage	Crimp die Crimpeinsatz
J01171A0001	SMC	G3 (RG-178B/U)	Gold (Standard)	solder/crimp löt/crimp	C1313	N01001A0010
J01171A0009	SMC	G3 (RG-178B/U)	Nickel	solder/crimp löt/crimp	C1313	N01001A0010
J01171A0011	SMC	G7 (RG-316/U)	Gold (Standard)	solder/crimp löt/crimp	C1303	N01001A0009
J01171A0019	SMC	G7 (RG-316/U)	Nickel	solder/crimp löt/crimp	C1303	N01001A0009
J01171A0021	SMC	G8 (RD-316)	Gold (Standard)	solder/crimp löt/crimp	C1314	N01001A0014
J01171A0029	SMC	G8 (RD-316)	Nickel	solder/crimp löt/crimp	C1314	N01001A0014

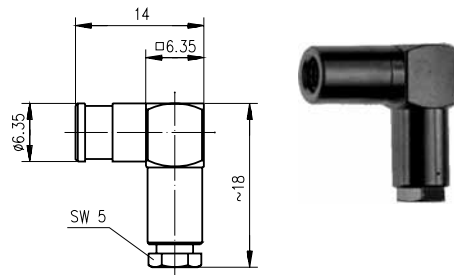
Angle Jack
Kabelwinkelbuchse

Order no. Bestell-Nr.	Series Serie	Cable group; cable Kabelgruppe; Kabel	Finish Oberfläche	Remarks Anmerkungen	Assembly Montage
J01161A0171	SMB	G3 (RG-178B/U)	Gold (Standard)	with pressure sleeve mit Stopfbuchsenverschraubung	C04
J01161A0179	SMB	G3 (RG-178B/U)	Nickel	with pressure sleeve mit Stopfbuchsenverschraubung	C04
J01161A0181	SMB	G7 (RG-316/U)	Gold (Standard)	with pressure sleeve mit Stopfbuchsenverschraubung	C04
J01161A0189	SMB	G7 (RG-316/U)	Nickel	with pressure sleeve mit Stopfbuchsenverschraubung	C04

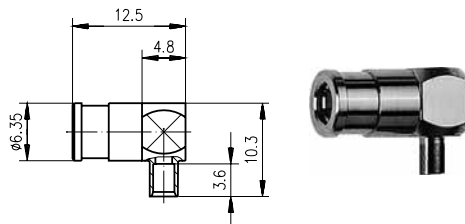

Order no. Bestell-Nr.	Series Serie	Cable group; cable Kabelgruppe; Kabel	Finish Oberfläche	Remarks Anmerkungen	Assembly Montage
J01161A0061	SMB	G11 (UT-85)	Gold (Standard)	solder/solder löt/löt	C05
J01161A0068	SMB	G11 (UT-85)	Tealloy (white bronze)	solder/solder löt/löt	C05
J01161A0518	SMB	G10 (UT-141)	Tealloy (white bronze)	solder/solder löt/löt	C05

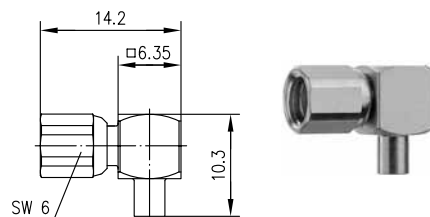

Order no. Bestell-Nr.	Series Serie	Cable group; cable Kabelgruppe; Kabel	Finish Oberfläche	Remarks Anmerkungen	Assembly Montage
J01171A0171	SMC	G11 (UT-85)	Gold (Standard)	solder/solder löt/löt	C05
J01171A0178	SMC	G11 (UT-85)	Tealloy (white bronze)	solder/solder löt/löt	C05
J01171A0201	SMC	G10 (UT-141)	Gold (Standard)	solder/solder löt/löt	C05
J01171A0208	SMC	G10 (UT-141)	Tealloy (white bronze)	solder/solder löt/löt	C05

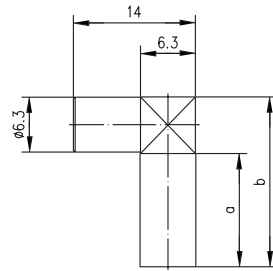

Order no. Bestell-Nr.	Series Serie	Cable group; cable Kabelgruppe; Kabel	Finish Oberfläche	Dimensions Abmessungen	Assembly Montage	Crimp die Crimpeinsatz
J01161A0401	SMB	G3 (RG-178B/U)	Gold (Standard)	a=7, b=13.35	C3413	N01001A0010
J01161A0408	SMB	G3 (RG-178B/U)	Tealloy (white bronze)	a=7, b=13.35	C3413	N01001A0010
J01161A0411	SMB	K 01252 D	Gold (Standard)	a=7, b=13.35	C1113	N01001A0010
J01161A0418	SMB	K 01252 D	Tealloy (white bronze)	a=7, b=13.35	C1113	N01001A0010
J01161A0661	SMB	G7 (RG-316/U)	Gold (Standard)	a=7, b=13.5	C3403	N01001A0009
J01161A0668	SMB	G7 (RG-316/U)	Tealloy (white bronze)	a=7, b=13.5	C3403	N01001A0009
J01161A0431	SMB	G8 (RD-316)	Gold (Standard)	a=7, b=13.35	C1114	N01001A0014
J01161A0438	SMB	G8 (RD-316)	Tealloy (white bronze)	a=7, b=13.35	C1114	N01001A0014
J01161A0261	SMB	G1 (RG-58C/U)	Gold (Standard)	a=13, b=19.5	C1105	N01001A0005
J01161A0268	SMB	G1 (RG-58C/U)	Tealloy (white bronze)	a=13, b=19.5	C1105	N01001A0005
J01161A0271	SMB	G5 (RG-223/U)	Gold (Standard)	a=13.5, b=20	C1105	N01001A0005
J01161A0278	SMB	G5 (RG-223/U)	Tealloy (white bronze)	a=13.5, b=20	C1105	N01001A0005

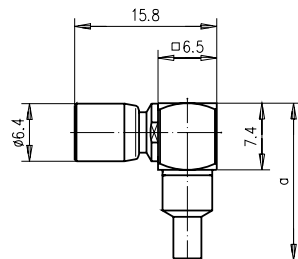

Order no. Bestell-Nr.	Series Serie	Cable group; cable Kabelgruppe; Kabel	Finish Oberfläche	Dimensions Abmessungen	Assembly Montage	Crimp die Crimpeinsatz
J01161A0141	SMB	G3 (RG-178B/U)	Gold (Standard)	a=18.4	C1013	N01001A0010
J01161A0149	SMB	G3 (RG-178B/U)	Nickel	a=18.4	C1013	N01001A0010
J01161A0151	SMB	G7 (RG-316/U)	Gold (Standard)	a=18.4	C1003	N01001A0009
J01161A0159	SMB	G7 (RG-316/U)	Nickel	a=18.4	C1003	N01001A0009
J01161A0161	SMB	G8 (RD-316)	Gold (Standard)	a=18.4	C1014	N01001A0014
J01161A0169	SMB	G8 (RD-316)	Nickel	a=18.4	C1014	N01001A0014

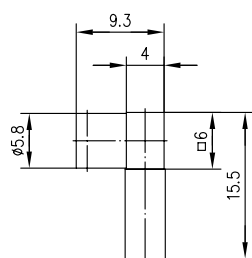

Order no. Bestell-Nr.	Series Serie	Cable group; cable Kabelgruppe; Kabel	Finish Oberfläche	Remarks Anmerkungen	Assembly Montage	Crimp die Crimpeinsatz
J01161A0088	SMB	G8 (RD-316)	Tealloy (white bronze)	short type kurze Ausführung	C1114	N01001A0014

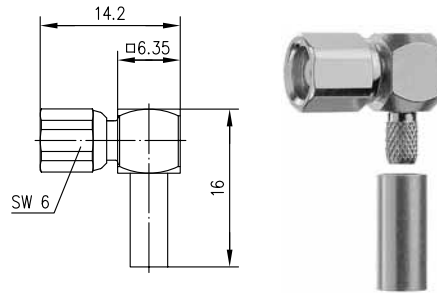
Angle Jack Crimp
Kabelwinkelbuchse Crimp

Order no. Bestell-Nr.	Series Serie	Cable group; cable Kabelgruppe; Kabel	Finish Oberfläche	Assembly Montage	Crimp die Crimpeinsatz
J01171A0181	SMC	G7 (RG-316/U)	Gold (Standard)	C1203	N01001A0009
J01171A0188	SMC	G7 (RG-316/U)	Telealloy (white bronze)	C1203	N01001A0009
J01171A0191	SMC	G8 (RD-316)	Gold (Standard)	C1214	N01001A0014
J01171A0198	SMC	G8 (RD-316)	Telealloy (white bronze)	C1214	N01001A0014

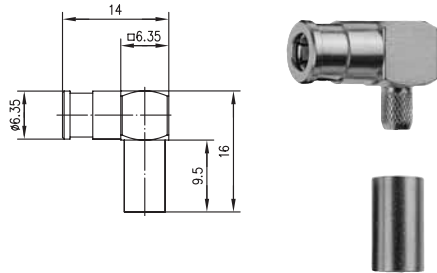

Order no. Bestell-Nr.	Series Serie	Cable group; cable Kabelgruppe; Kabel	Finish Oberfläche	Remarks Anmerkungen	Assembly Montage
J01161A0681	SMB	G12 (0.315/1.95-3.7)	Gold (Standard)	solder/crimp löt/crimp	C1104

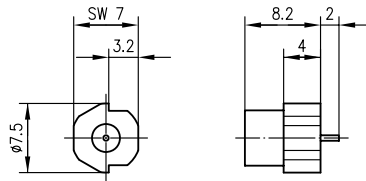
Straight PCB Receptacle, female, in SMT
Buchse in SMT

Order no. Bestell-Nr.	Series Serie	Finish Oberfläche	Remarks Anmerkungen	Mount. dim. Einbaumaß
J01161A0631	SMB	Gold (Standard)	Edge-Mount-Type	Z95

Angle PCB Receptacle, female
Winkelanbaubuchse für gedruckte Schaltungen

8.16

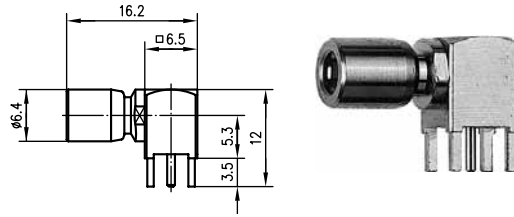

Order no. Bestell-Nr.	Series Serie	Finish Oberfläche	Mount. dim. Einbaumaß
J01161A0571	SMB	Gold (Standard)	Z25

T Adaptor
T-Stück

8.17

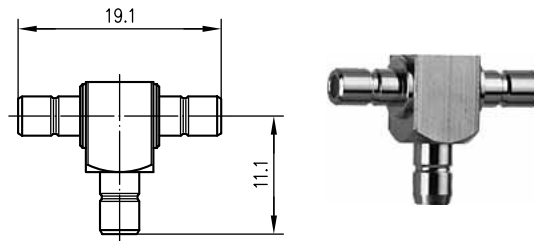

Order no. Bestell-Nr.	Series Serie	Finish Oberfläche	Remarks Anmerkungen
J01162A0001	SMB	Gold (Standard)	m-m-m Sti-Sti-Sti
J01162A0009	SMB	Nickel	m-m-m Sti-Sti-Sti

Termination, female
Abschlusswiderstand

8.18

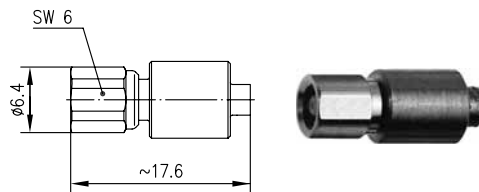

Order no. Bestell-Nr.	Series Serie	Finish Oberfläche	Remarks Anmerkungen
J01176A0001	SMC	Gold (Standard)	1 W; 34 dB; 2 GHz