

Cable Terminators Kabeldirektanschlüsse

Contents

18.1	Cable Terminator for Printed Circuits	315
18.2	Angle Cable Terminator for Printed Circuits	316

Übersicht

18.1	Kabelanschluss für gedruckte Schaltungen . .	315
18.2	Kabelwinkelanschluss für gedruckte Schaltungen	316

Cable terminators are used for direct soldering of coax-cables onto printed circuits boards. Straight and angle types with 1, 2 or 4 pin terminations allow optimal solutions for various applications.

Kabeldirektanschlüsse ermöglichen das direkte Einlöten von Koax-Kabeln in Leiterplatten. Gerade- und Winkelausführungen mit 1, 2 oder 4 Lötanschlüssen lassen je nach Anforderung eine optimale Lösung finden.

Cable Terminator for Printed Circuits Kabellanschluss für gedruckte Schaltungen

18.1

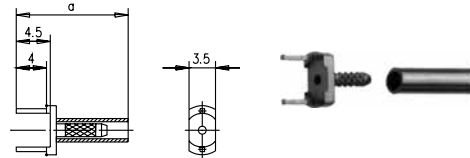

Order no. Bestell-Nr.	Cable group; cable Kabelgruppe; Kabel	Remarks Anmerkungen	Dimensions Abmessungen	Mount. dim. Einbaumaß	Assembly Montage	Crimp die Crimpeinsatz
H01000A0017	G3 (RG-178B/U)	solder/crimp löt/crimp	a=14.8	Z26	D0213	N01001A0010
H01000A0027	G7 (RG-316/U)	solder/crimp löt/crimp	a=14.8	Z26	D0203	N01001A0009
H01000A0037	G8 (RD-316)	solder/crimp löt/crimp	a=14.8	Z26	D0214	N01001A0014
H01000A0047	G3 (RG-178B/U)	solder/crimp löt/crimp	a=12.4	Z26	D0313	N01001A0010
H01000A0057	G7 (RG-316/U)	solder/crimp löt/crimp	a=12.4	Z26	D0303	N01001A0009
H01000A0067	G8 (RD-316)	solder/crimp löt/crimp	a=12.4	Z26	D0314	N01001A0014

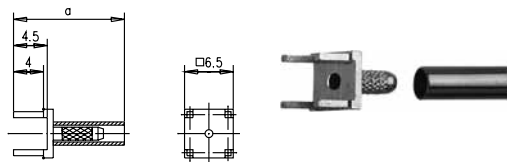

Order no. Bestell-Nr.	Cable group; cable Kabelgruppe; Kabel	Remarks Anmerkungen	Dimensions Abmessungen	Mount. dim. Einbaumaß	Assembly Montage	Crimp die Crimpeinsatz
H01000A0077	G3 (RG-178B/U)	solder/crimp löt/crimp	a=14.8	Z25	D0213	N01001A0010
H01000A0087	G7 (RG-316/U)	solder/crimp löt/crimp	a=14.8	Z25	D0203	N01001A0009
H01000A0097	G8 (RD-316)	solder/crimp löt/crimp	a=14.8	Z25	D0214	N01001A0014
H01000A0107	G3 (RG-178B/U)	solder/crimp löt/crimp	a=12.4	Z25	D0313	N01001A0010
H01000A0117	G7 (RG-316/U)	solder/crimp löt/crimp	a=12.4	Z25	D0303	N01001A0009
H01000A0127	G8 (RD-316)	solder/crimp löt/crimp	a=12.4	Z25	D0314	N01001A0014

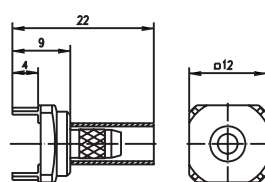

Order no. Bestell-Nr.	Cable group; cable Kabelgruppe; Kabel	Remarks Anmerkungen	Mount. dim. Einbaumaß	Assembly Montage	Crimp die Crimpeinsatz
H01000A0287	G1 (RG-58C/U)	solder/crimp löt/crimp	Z06	D0705	N01001A0005

18.1

Cable Terminator for Printed Circuits Kabelanschluss für gedruckte Schaltungen

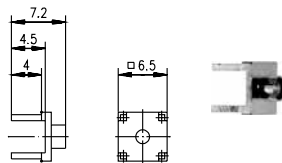

Order no. Bestell-Nr.	Cable group; cable Kabelgruppe; Kabel	Remarks Anmerkungen	Mount. dim. Einbaumaß	Assembly Montage
H01000A0131	G11 (UT-85)	Au; solder/solder Au; lötlöt	Z25	D10
H01000A0137	G11 (UT-85)	Sn; solder/solder Sn; lötlöt	Z25	D10
H01000A0141	G10 (UT-141)	Au; solder/solder Au; lötlöt	Z25	D10
H01000A0147	G10 (UT-141)	Sn; solder/solder Sn; lötlöt	Z25	D10

Angle Cable Terminator for Printed Circuits Kabelwinkelanschluss für gedruckte Schaltungen

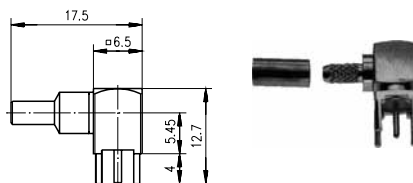

Order no. Bestell-Nr.	Cable group; cable Kabelgruppe; Kabel	Remarks Anmerkungen	Mount. dim. Einbaumaß	Assembly Montage	Crimp die Crimpeinsatz
H01000A0157	G3 (RG-178B/U)	5 pin terminations, SN, solder/crimp 5 Lötanschlüsse, SN, Löt/Crimp	Z25	D0413	N01001A0010
H01000B0167	G7 (RG-316/U)	5 pin terminations, SN, solder/crimp 5 Lötanschlüsse, SN, Löt/Crimp	Z25	D0403	N01001A0009
H01000B0177	G8 (RD-316)	5 pin terminations, SN, solder/crimp 5 Lötanschlüsse, SN, Löt/Crimp	Z25	D0414	N01001A0014

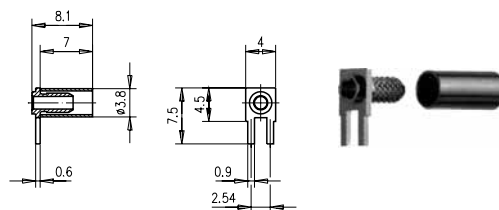

Order no. Bestell-Nr.	Cable group; cable Kabelgruppe; Kabel	Remarks Anmerkungen	Mount. dim. Einbaumaß	Assembly Montage	Crimp die Crimpeinsatz
H01000A0191	G7 (RG-316/U)	2 pin terminations; Au 2 Lötanschlüsse; Au	Z56	D0603	N01001A0009

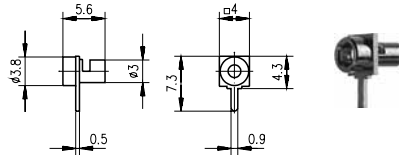

Order no. Bestell-Nr.	Cable group; cable Kabelgruppe; Kabel	Remarks Anmerkungen	Mount. dim. Einbaumaß	Assembly Montage
H01000A0231	G3 (RG-178B/U)	1 pin termination; Au 1 Lötanschluss; Au	Z41	D06
H01000A0237	G3 (RG-178B/U)	1 pin termination; Sn 1 Lötanschluss; Sn	Z41	D06
H01000A0241	G7 (RG-316/U)	1 pin termination; Au 1 Lötanschluss; Au	Z41	D06
H01000A0247	G7 (RG-316/U)	1 pin termination; Sn 1 Lötanschluss; Sn	Z41	D06

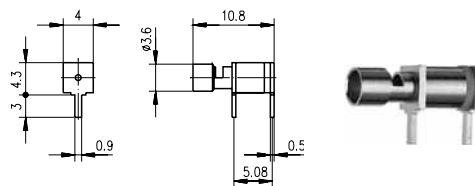

Order no. Bestell-Nr.	Cable group; cable Kabelgruppe; Kabel	Remarks Anmerkungen	Mount. dim. Einbaumaß	Assembly Montage
H01000A0221	G3 (RG-178B/U)	2 pin terminations; Au 2 Lötanschlüsse; Au	Z71	D09
H01000A0201	G7 (RG-316/U)	2 pin terminations; Au 2 Lötanschlüsse; Au	Z71	D09
H01000A0207	G7 (RG-316/U)	2 pin terminations; Sn 2 Lötanschlüsse; Sn	Z71	D09